

MAINSAIL

MEASURE FORM MAINSAIL

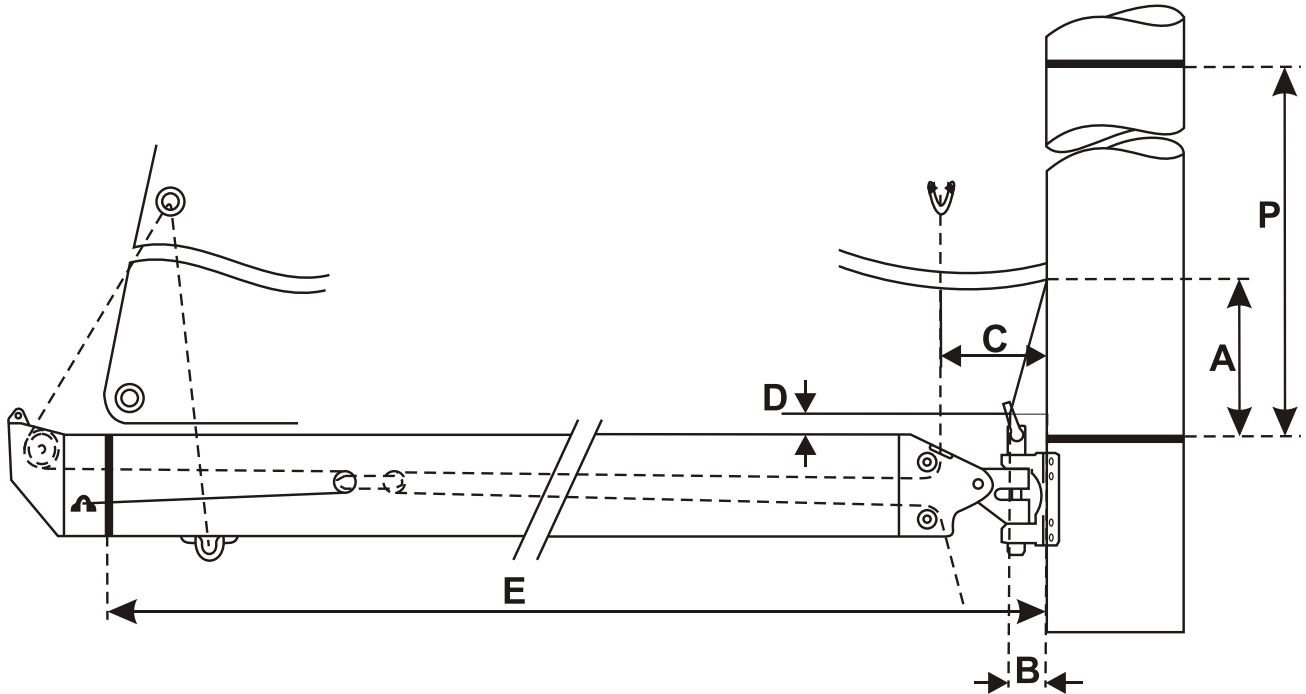

P	
E	
Tack A	
Tack B	
Tack C	
Tack D	
H1	
H2	
Number on old mast slides	
Diameter on rope to boom	

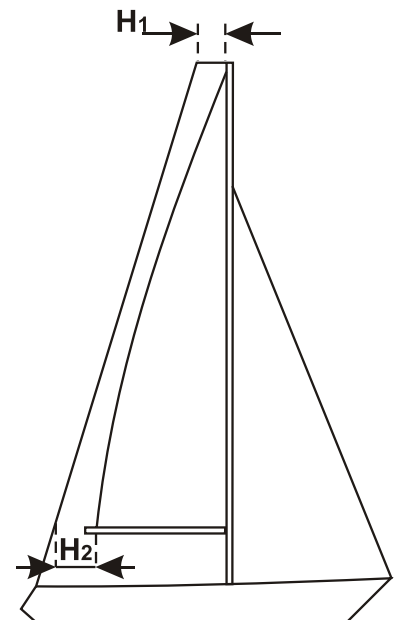

Type the measures on your order page. You've received the link when the order was created.

MEASURE GUIDE MAINSAIL

LUFF (P)

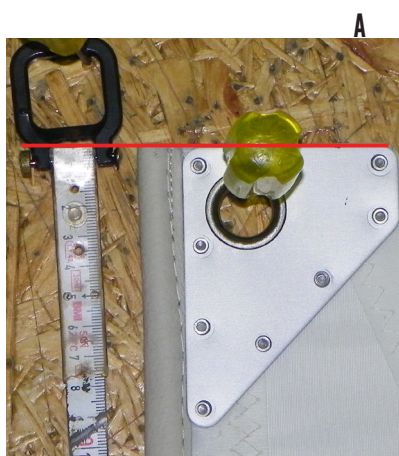

The luff is measured from the top of the sail along the red line (Fig. A).

A batten or anything similar is placed along the foot, and then measure to the red line (Fig. B).

If the sail is obliquely cut by the boom, you must measure where the upper edge of the boom normally is (Fig. D).

Measure the whole length of the luff (Fig. C).

Note down the measure in meters in the box P on the measuring form. Eg. 9.35 meters.

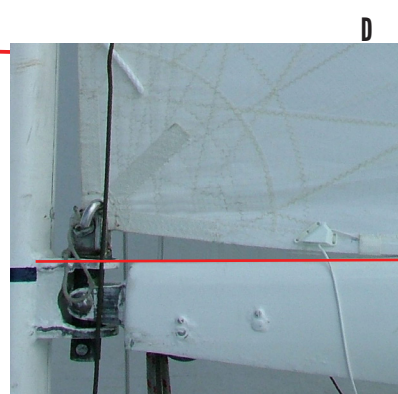
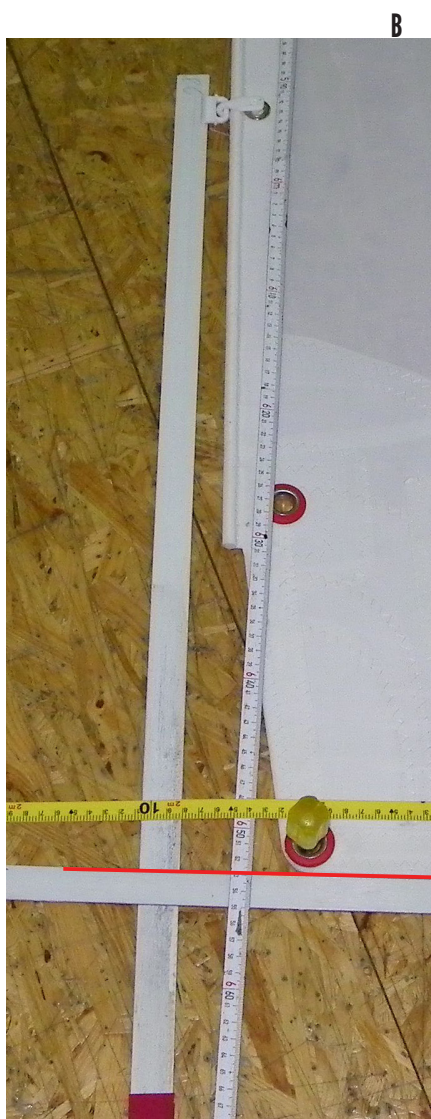

FOOT (E)

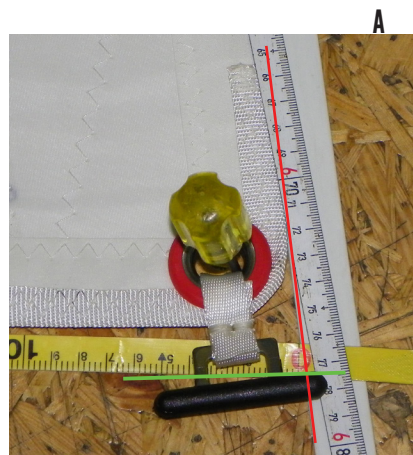
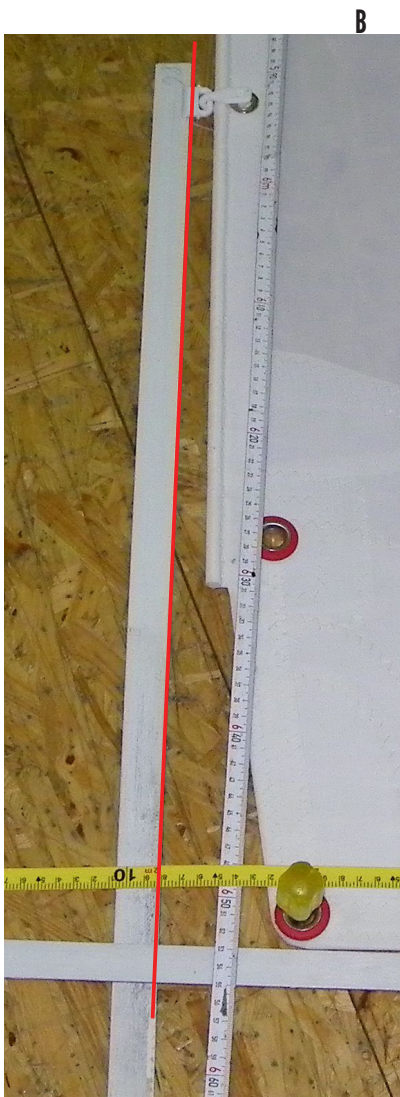

The foot (E) is measured from the leech to the luff at the bottom edge of the sail.

Place a batten or anything similar along the leech and past the foot (Fig. A). The measuring tape is placed on the top edge of the slide (or the rope) which is mounted in the boom where the sail is attached (see green line in Figure A). You must measure from the part that is visible when the sail is attached to the boom.

Then place a batten or anything similar along the luff by the slides - on the part of the slides that are visible when the sail sits on the mast (Fig. B). If you don't have slides in the luff, but rope, you have to measure from the inside of the ropes - the visible part when the sail is attached.

Measure the length between the red lines (see Fig. A and B).

Note down the measure in meters in the box E on the measuring form. Eg. 3.45 meters.

TACK A, B, C, D

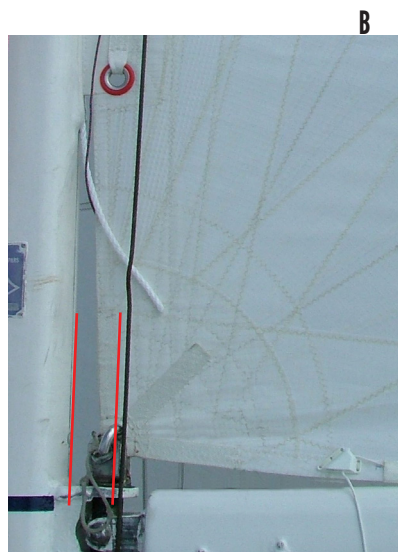
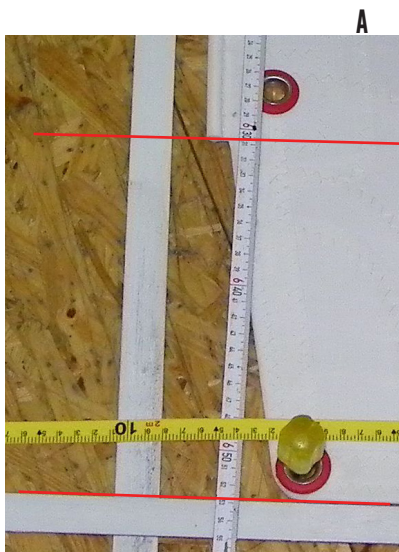

Tack A is from the place where the rope ends on the luff and down to the boom. (fig. A).

Tack B is the distance from the mast to the goose neck / where the mainsail is attached (fig. B).

Tack C is the distance from the mast to the first reef hole (fig. C).

Tack D is the distance from the goose neck down to the boom (fig. D).

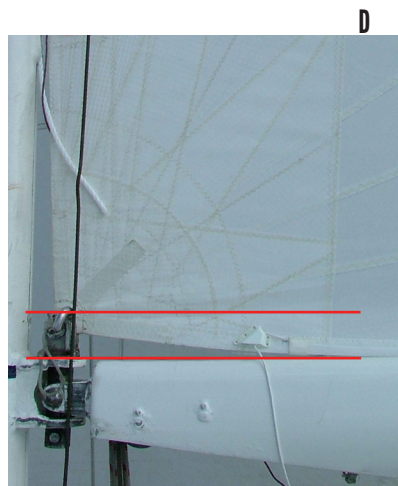
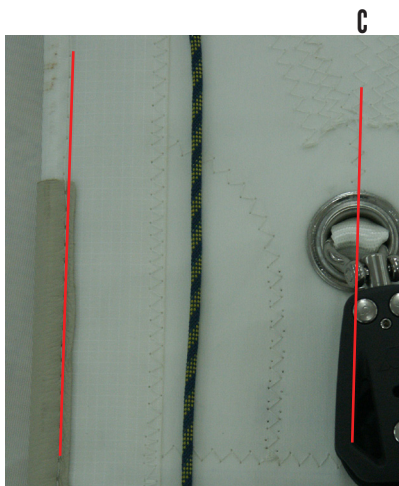

H1 and H2

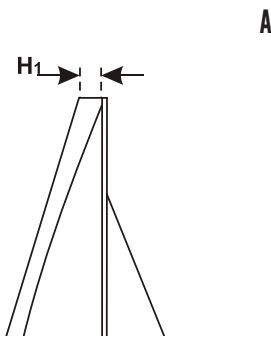

A



B



C

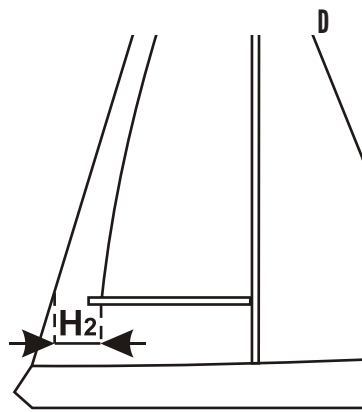

D

To determine how large the roach can be on your mainsail, without hitting the backstay, you have to measure the clearance from the backstay into the mast / the sail.

H1 has to be measured from the top of the sail once it is set. Measure from the mast out to the backstay along the top of the sail (Fig. A and Fig. B).

If you don't have the opportunity to do this measurement, you can disconnect the sail and measure the width from the mast edge to the rear edge of the sail (wide aluminum or nylon fitting) at the top of the mainsail. This measure is typically 10-15cm (Fig. C).

H2 is measured from the back edge of the sail on the boom, out to the backstay (Fig. D).

SLIDES

ROUNDED BOTTOM

Find the number on your old slides and match with the number on the right (eg. A007, HA89, etc.).

Otherwise measure your slide, and match it with the dimensions in the table.

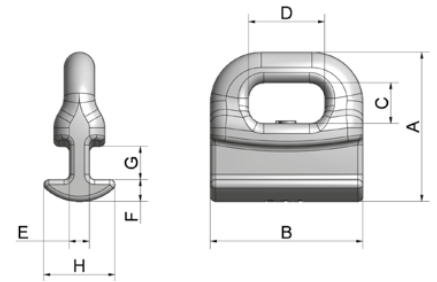

Product description	A	B	C	D	E	foot F	depth G	width H	B / I no	For profile
Sail Slide 1334	21	25	5,5	16	3	3,5	3,5	10,5	A013	Seldén 1334/HA558
Sail Slide 1335	28	29	8	16	4	4,5	4,5	14	A014	Seldén 1335/HA458
Sail Slide 1336	34	39	8,5	20	4	7	8	15	A015	Seldén 1336

FLAT BOTTOM

Find the number on your old slides and match with the number on the right (eg. A007, HA89, etc.).

Otherwise measure your slide, and match with the dimensions in the table.

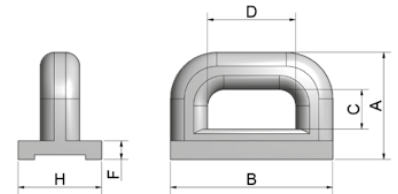

Product description	A	B	C	D	E	foot F	depth G	width H	B / I no	For profile
Sail Slide HA89	21	32	7,5	19	7,5	3,5	3,5	16	A007	HA89
Sail Slide HA90	23	35	8,5	19	8	4	4	18	A008	HA90
Sail Slide HA91	25	40	9,5	21	8	5,5	5	21	A009	HA91

MEASURE PROFILE

If you don't know the type of the slides or thickness of the rope to be covered on the mast / boom you can fill in the table above. You can also find the correct slide in the table below.

MAST Slides/rope

1		1	
2		2	
		3	
		4	

BOOM Slides/rope

1		1	
2		2	
3		3	
		4	

CARS

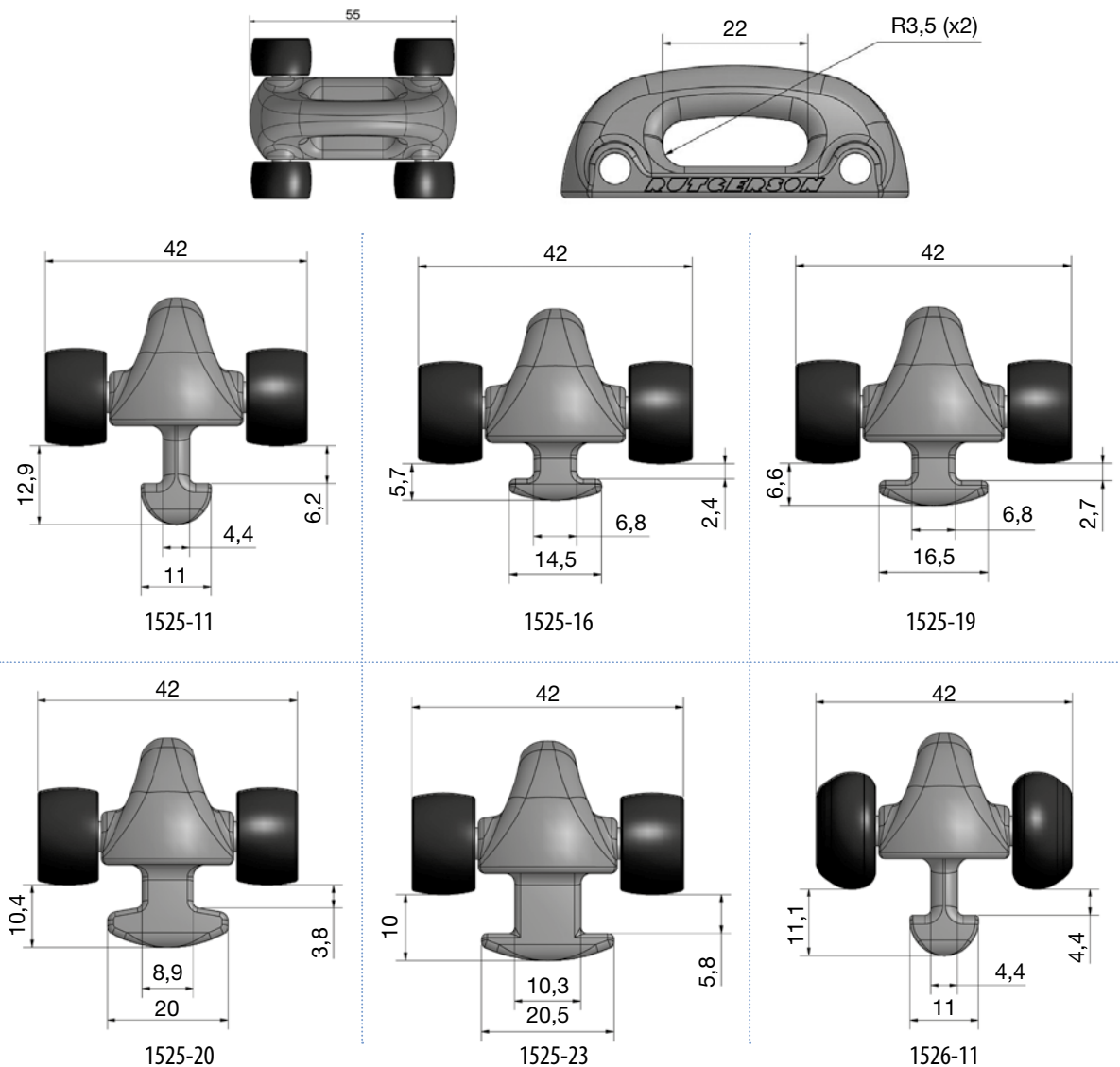

Part no	Product description	Wheel Ø [mm]	Recommended fitting	Packed per
1525-11	Pressure absorbing slide 11mm	15,5	1490, 1490G or Webbing	10
1525-16	Pressure absorbing slide 16mm	15,5	1490, 1490G or Webbing	10
1525-19	Pressure absorbing slide 19mm	15,5	1490, 1490G or Webbing	10
1525-20	Pressure absorbing slide 20mm	15,5	1490, 1490G or Webbing	10
1525-23	Pressure absorbing slide 23mm	15,5	1490, 1490G or Webbing	10
1526-11	Pressure absorbing slide 11mm (big wheels)	19,5	1490, 1490G or Webbing	10
1526-16	Pressure absorbing slide 16mm (big wheels)	19,5	1490, 1490G or Webbing	10

HEADSAIL (GENOA/JIB)

MEASURING OF OLD GENOA/JIB

Please write which side the UV-protection is going to be fitted on the sail when it's rolled out - starboard or port.

Please also write which color the UV-protection is going to have. See colors on the last pages.

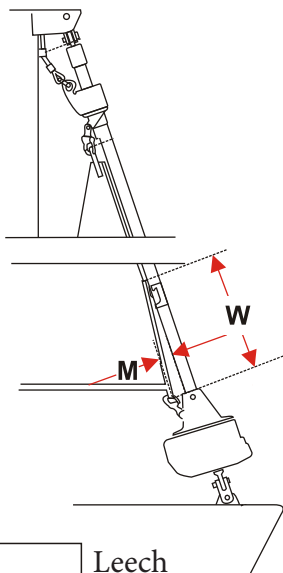

A		Leech
M		
U		Foot
W		
V		Luff

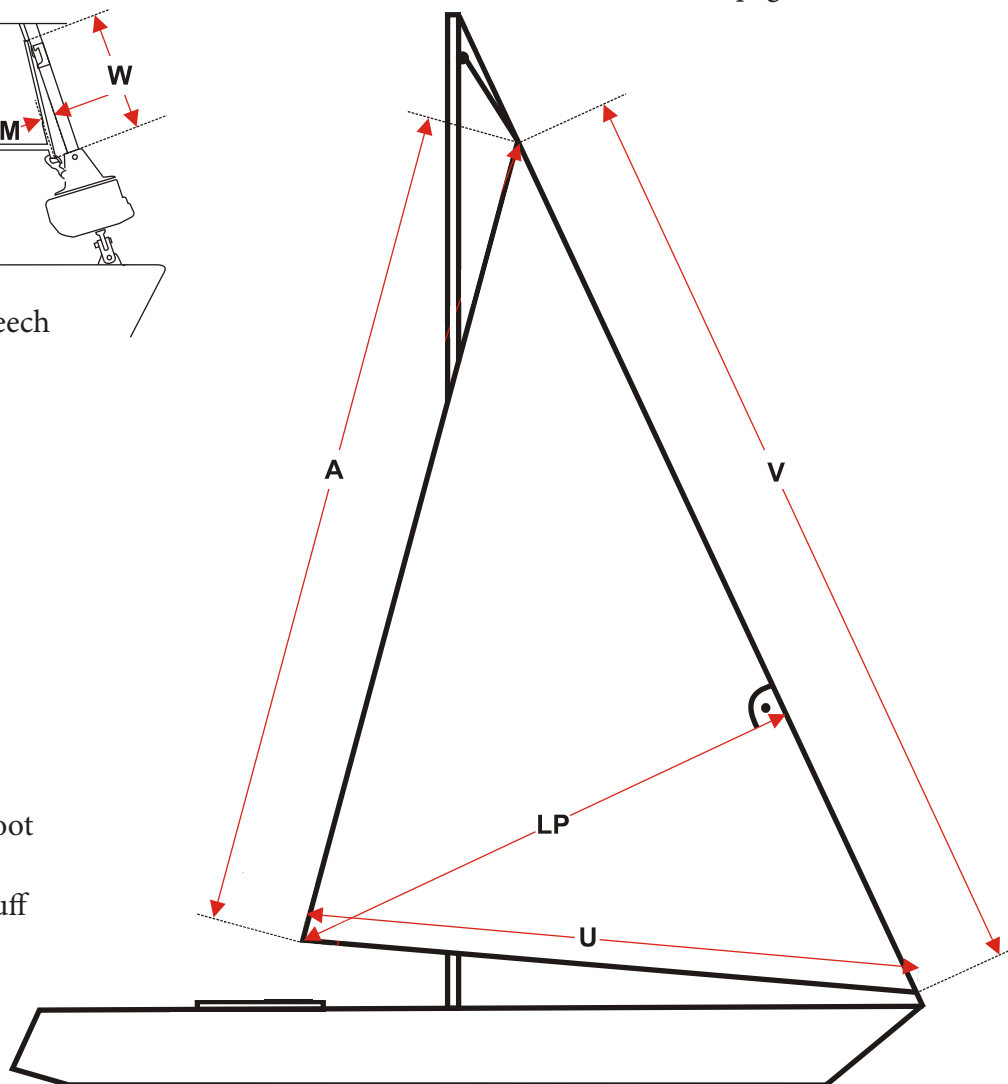

UV-protection color:
 UV-protection side:
 Diameter of rope on luff:

MEASURE GUIDE GENOA/JOB

LUFF (V)

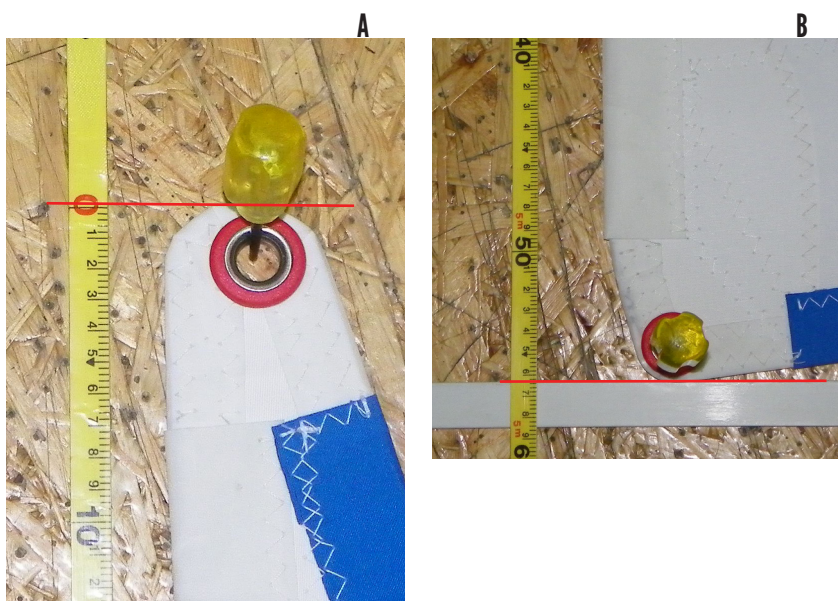

Luff (V) is measured from the top of the sail down to the bottom of the sail.

The measure tape is placed at the top of the sail (Fig. A).

A batten or anything similar is then placed along the foot of the sail (Fig. B).

You measure the length between the red lines (see Fig. A and B).

Note down the measure in meters in the box V on the measuring form Eg. 3.45 meters.

SPECIAL ABOUT ROLL GENOA

If you have a furled headsail (roll genua) please note that we always use measures from edge sail to edge sail. We then put a 6 cm strap/webbing on top and bottom.

That means that the total length of the luff will be 6 cm longer. Please make sure this will fit on your roll-system.

If your old sail doesn't have straps/webbing on top and bottom, but eyes/rings inside the sail, then measure from inside eye on bottom to inside eye on top.

If you are in doubt please take measure Y (max luff) on page 14.

FOOT (U)

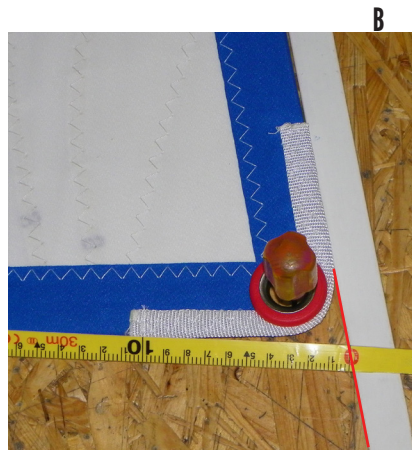

The foot (U) is measured from the luff's edge to the leech's edge.

Place a batten or similar along the luff (Fig. A) and along the leech (Fig. B) past the lower edge of the sail. Then measure between the battens (the red lines in Fig. A and Fig. B).

Note down the measure in meters in the box U on the measuring form. Eg. 3.45 meters.

LEECH (A)

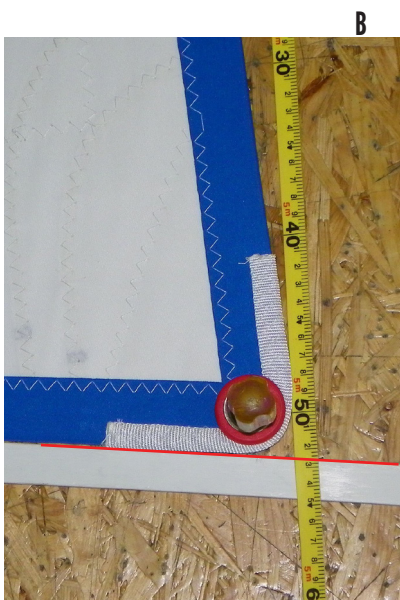
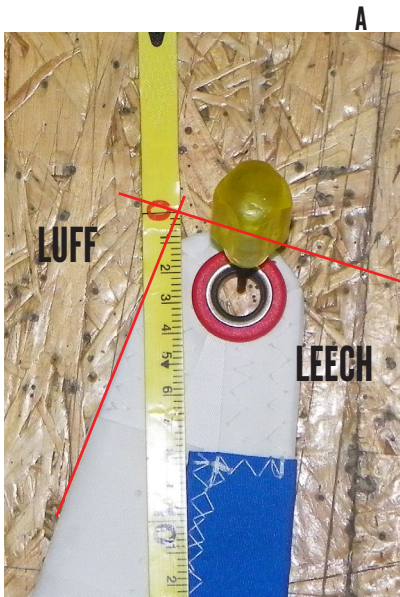

Leech (A) is measured a little different than luff and foot.

It is measured from the top of the sail at the luff (Fig. A) down to the foot's outer edge (Fig. B). While measuring, the tape measure will look as if it crosses the top (Fig. C).

Place a batten or something similar along the foot's edge (Fig. B).

A furled sail is shown in the image. If there are hanks/piston hanks on the sail, they aren't measured. Measurements are therefore still from the sail edges.

Note down the measure in meters in the box A on the measuring form Eg. 10,45 meters.

ROLL SYSTEM

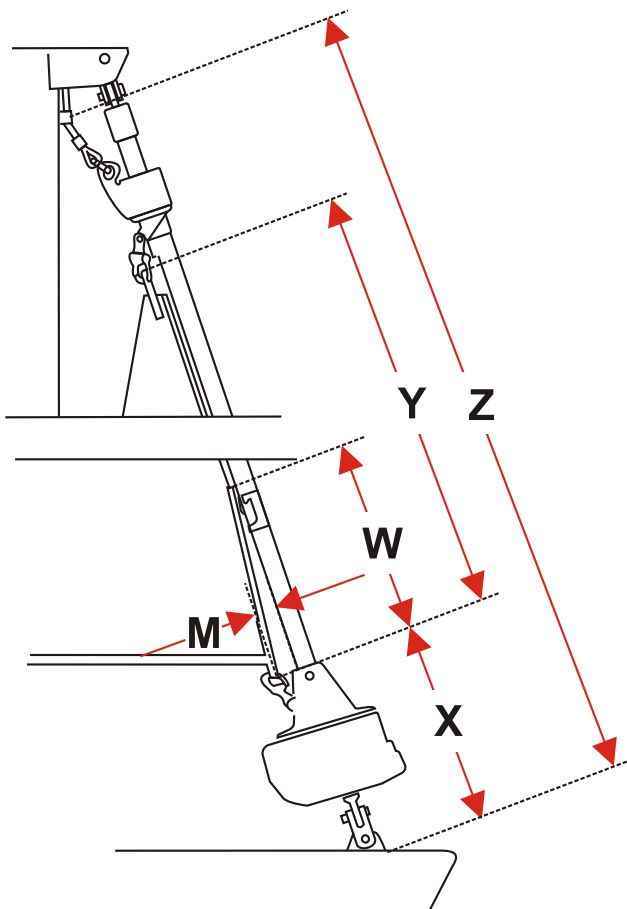

When you measure your old sails, the only measures needed are M, W and the diameter of the ropes to enter the profile of the roll system.

M is measured from the cutting edge of the sail all the way down where it is attached on the roll and into the profile of the roll system.

W is measured from the shackles' inner upper edge and up to the beginning of the groove where the sail runs into the profile.

The diameter of the luffs rope, which runs into the profile, is measured with a caliper. If you specify which brand and model roll system you have, then we have the measures in advance. However, we would love to have the measures from you as your profile rails may be different than the default one.

Please note on which side you want UV on the sail when it is rolled out - starboard or port.

Also note which color UV fabric you want. See color scheme on the last pages.

MEASURING RIG

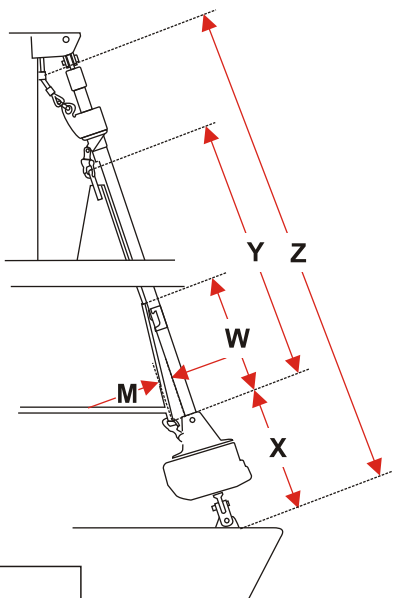

A	
B	
C	
D	
E	
F	
I	
J	
K	
LP	
M	
O	
R	
U	
W	
V	
X	
Y	
Z	

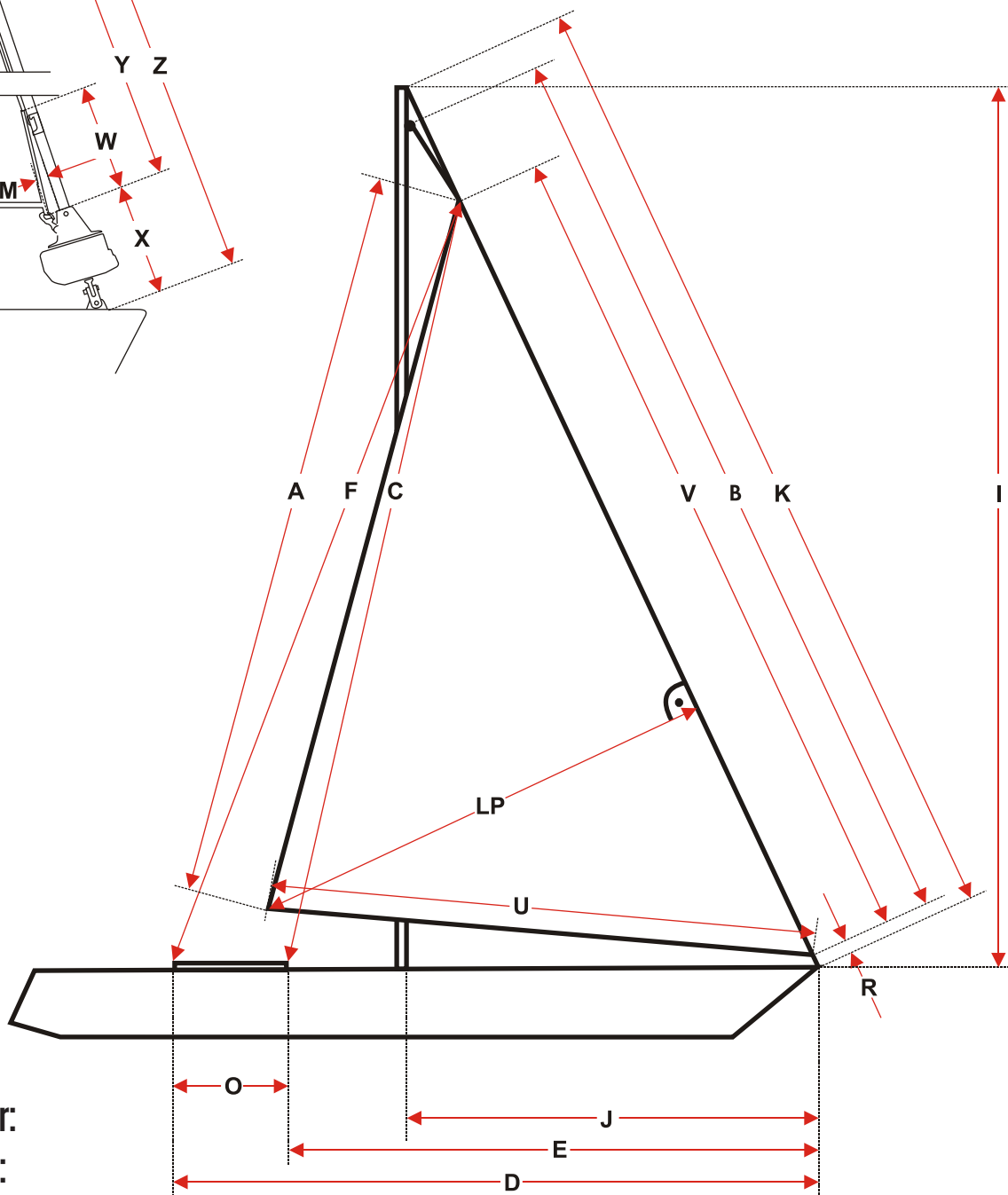

UV-protection color:
 UV-protection side:
 Diameter of rope on luff:

LAZYJACK / LAZYBAG

MEASURE FORM LAZYBAG - IN BOOM

Note which color the lazybag needs. See color scheme on the last pages.

A	B	C	D	E	F	G	H	P	R

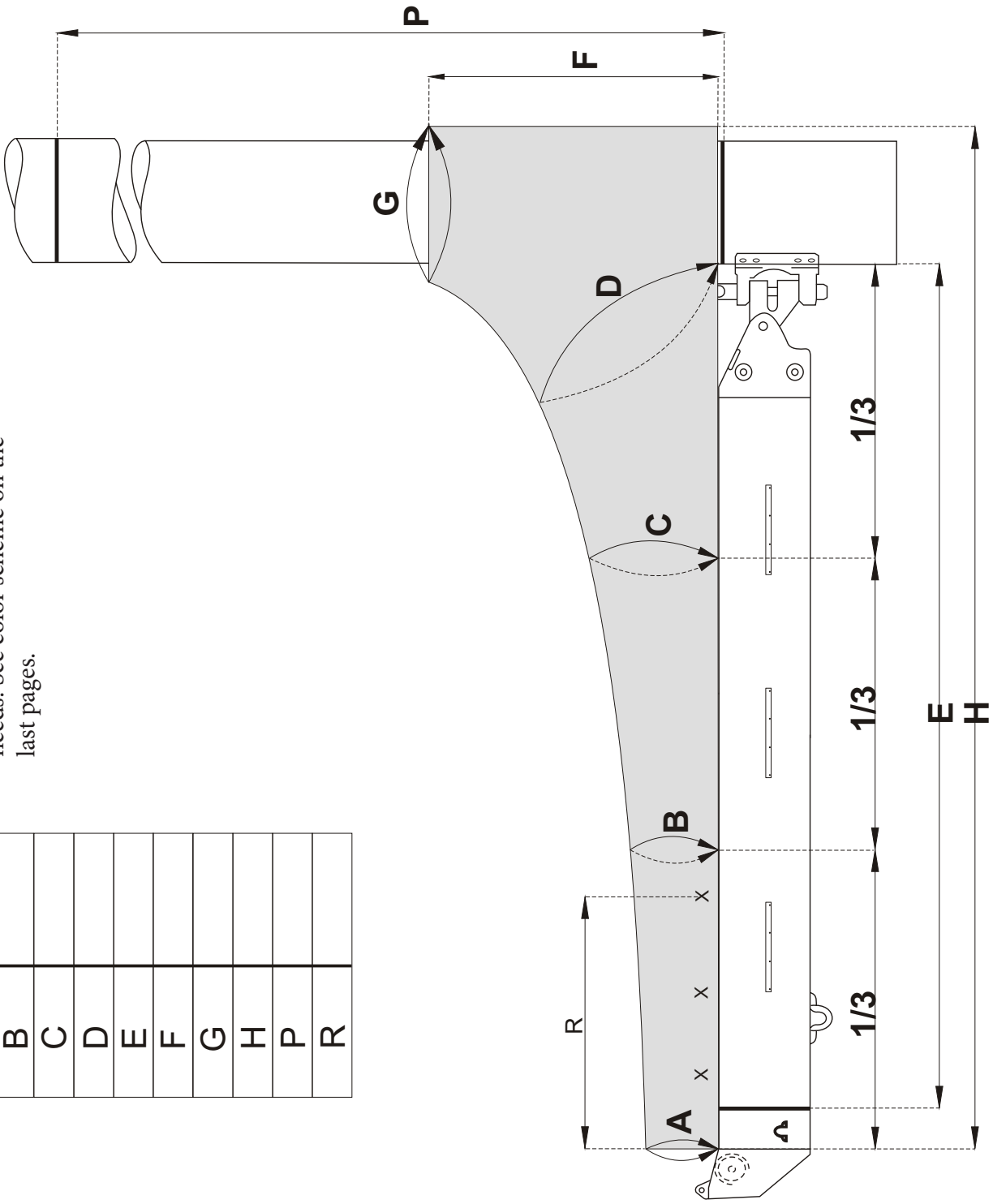

GUIDE LAZYJACK/LAZYBAG

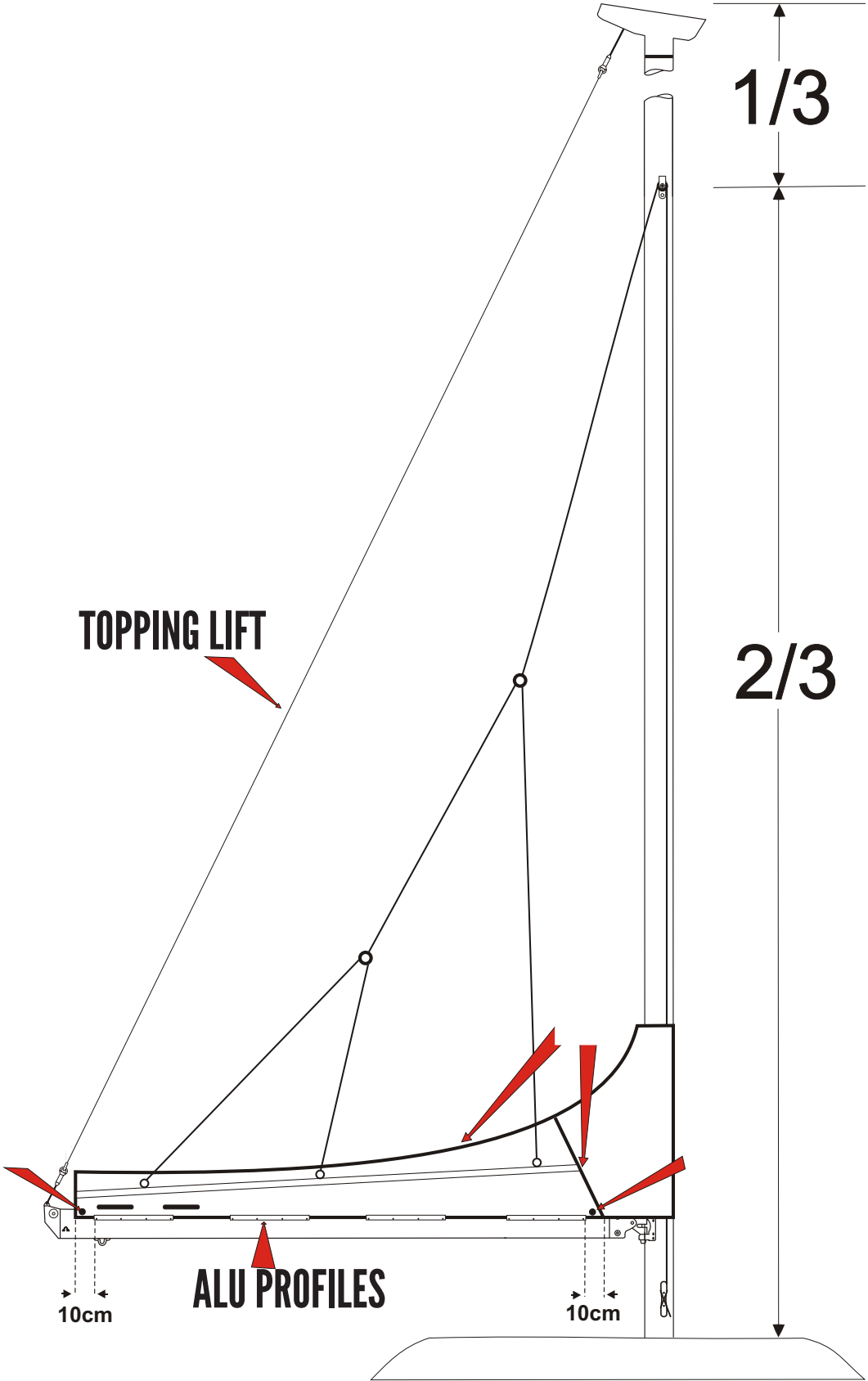

PLACEMENT OF ALU PROFILES

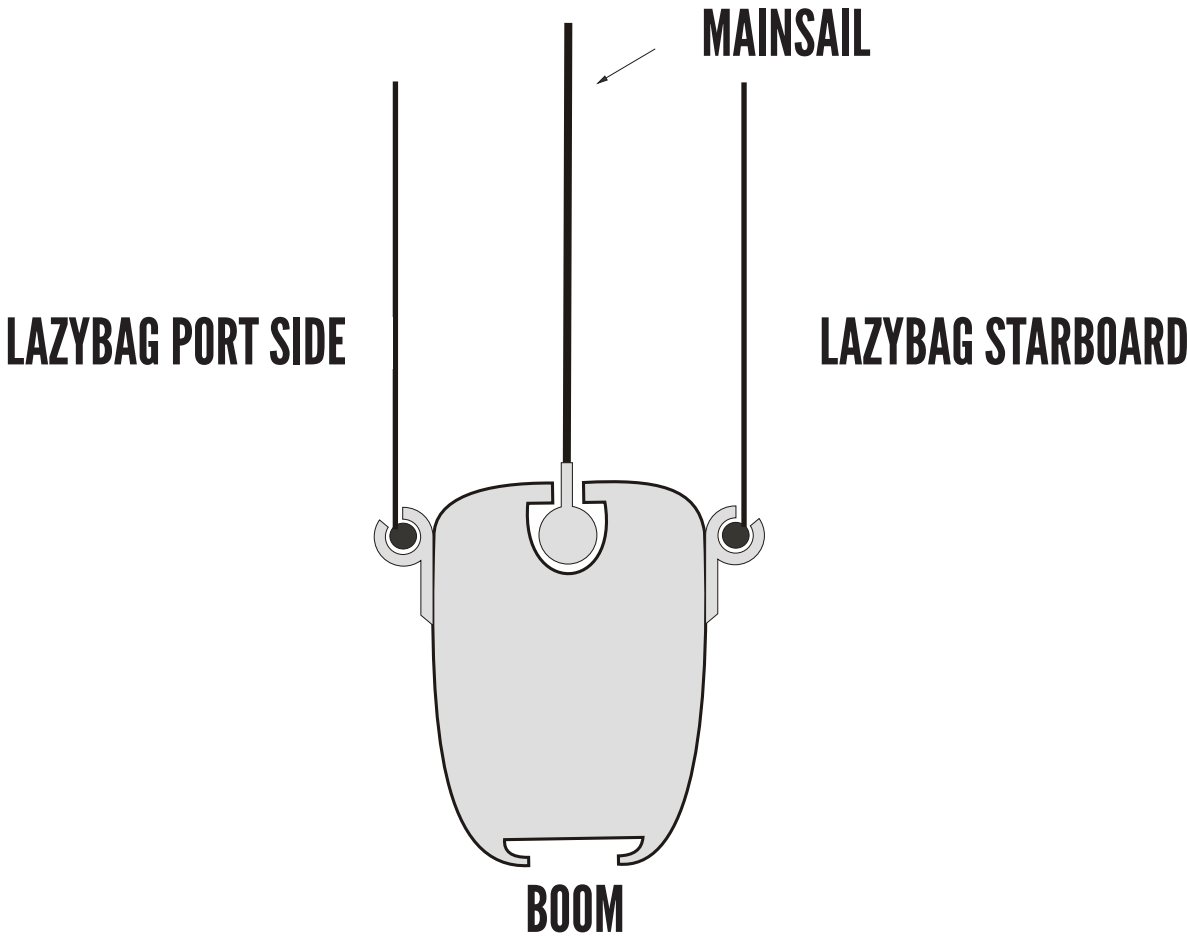
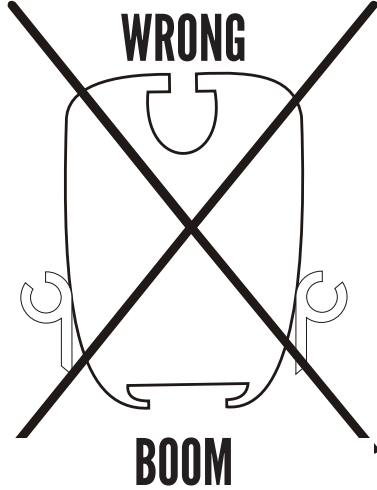
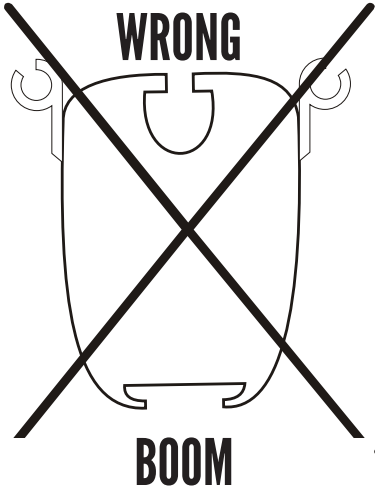
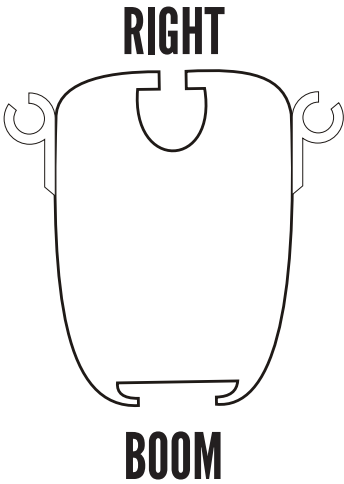

COLORS



Navy Blue - 5058



Silver - 5035



Jet Black - 5032
(Jet Black)



Captain Navy - 5057



Forest Green - 5040



Burgundy - 5034



Marine Blue - 5031



Ocean Blue - 5055



Jockey Red - 3728
(Paris Red)



Oyster - 5030



Pacific Blue - 5023

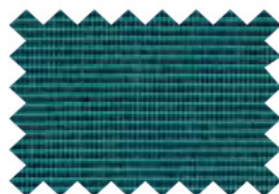

Teal Tweed - 5056



Dune - 5026



White - 5020
(Natural)